



FIRE BLOCK 120

LONG-LASTING FIRE PROTECTION

YAWAL FIRE BLOCK 120 TM 90EI - SYSTEM FEATURES

YAWAL FIRE BLOCK 120 TM 90EI allows for manufacturing a wide selection of fire protection partitions with fire resistance class EI 120. It is compatible with TM 75 EI system.

System TM 90EI meets the requirement of up-to-date Technical Approval. Max. dimensions of fire protection wall that may be constructed using this system are as follows: height: 4000 mm; width: 5240 mm.

Photo: Neophilology – Silesian University, Sosnowiec
Design: Biuro Architektoniczne Taczewski, Katowice
Aluminium manufacturer: ACARI Sp. z o.o., Cracow

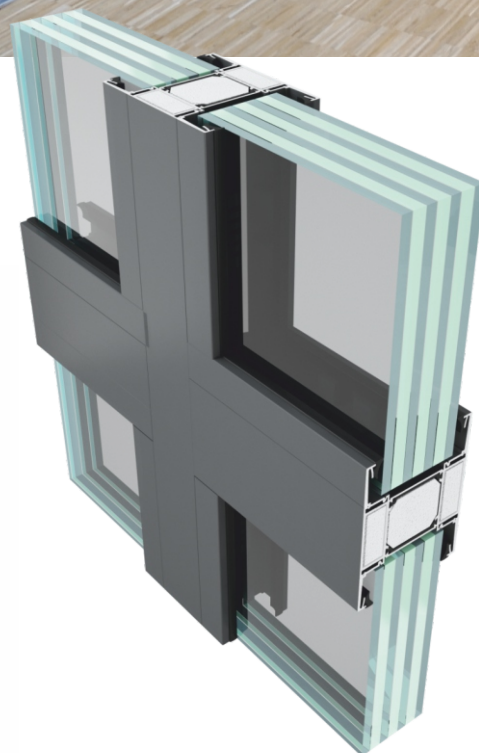

ADVANTAGES OF THE SYSTEM

- materials classified as NRO - fire retardants,
- thermal insulation,
- used infills are up to 100 mm thick,
- possibility of manufacturing internal walls without fire resistance properties acc. to the Technical Approval,
- possibility of installing doors of YAWAL TM 75 EI system in the walls.

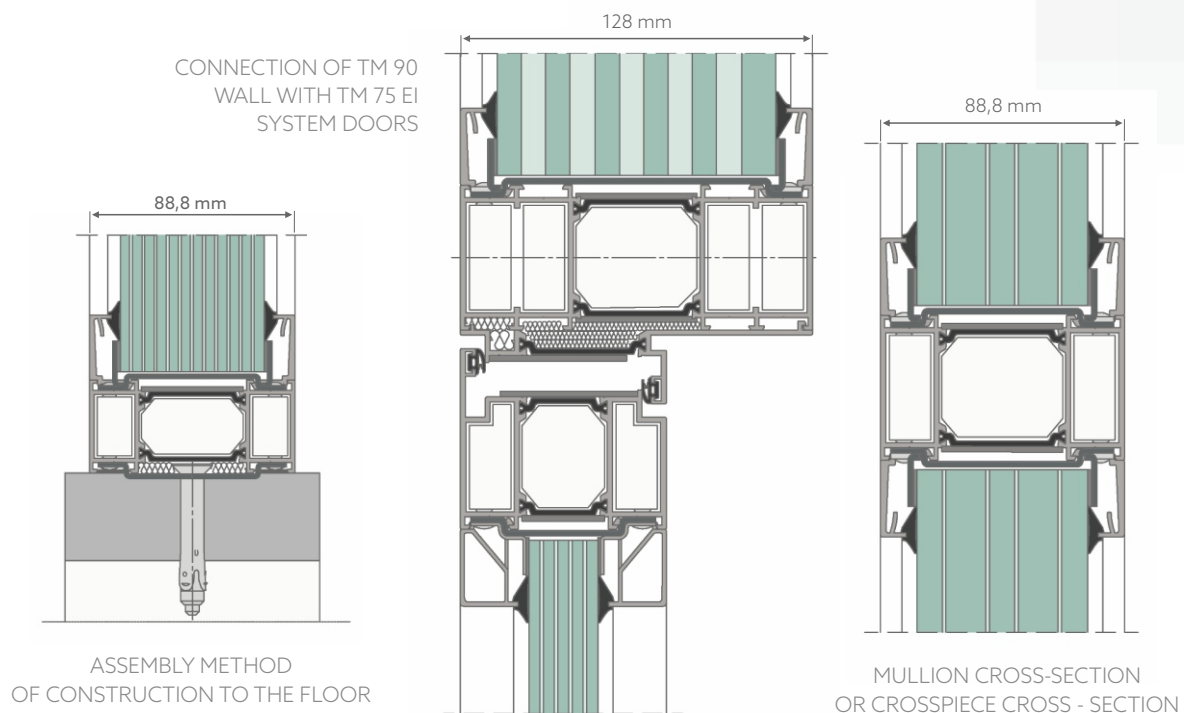

TECHNICAL PARAMETERS - TM 90EI

Fire resistance classification	EI 120 acc. to PN-EN 13501-2
Air permeability	class 4 acc. to PN-EN 12152
Water tightness	class R7 acc. to PN-EN 12154
Fire classification	EI 120 acc. to PN-EN 13501-2+A1
Wind load resistance	class C1 acc. to PN-EN 12210
Acoustic insulation	$R_w=43$ dB acc. to PN-B-02151-3
Heat transfer coefficient	$U_f= 2,4\div 2,8$ W/m ² K acc. to PN-EN ISO 6946
Corrosion category	C1 - C4 acc. to PN-EN ISO 12944-2
Internal wall impact strength	IVb acc. to ETAG nr 003
Wall offset from vertical	10°

SYSTEM CHARACTERISTICS

Minimal inwards opened window construction width visible from the outside	Frame profile	68,2 mm
Structural depth	Frame profile	88,8÷120 mm
Glazing bead height		28,0 mm
Thickness of infills / glazing		to 100 mm